



Shielded Power Inductors – DS3316P



Coilcraft will continue to manufacture and support the DS3316P indefinitely, however for new designs, consider the MSS1038 as an alternative. The MSS1038 series is more cost effective, features a smaller footprint, lower profile, lower DCR and better current handling.

Core material Ferrite

Terminations RoHS compliant electroplated gold (<50 µin) over nickel over phos bronze. Other terminations available at additional cost.

Weight 0.82–0.87 g

Ambient temperature –40°C to +85°C with Irms current

Maximum part temperature +125°C (ambient + temp rise)

Storage temperature Component: –40°C to +125°C.

Tape and reel packaging: –40°C to +80°C

Resistance to soldering heat Max three 40 second reflows at +260°C, parts cooled to room temperature between cycles

Moisture Sensitivity Level (MSL) 1 (unlimited floor life at <30°C / 85% relative humidity)

Failures in Time (FIT) / Mean Time Between Failures (MTBF)

38 per billion hours / 26,315,789 hours, calculated per Telcordia SR-332

Packaging 1000 per 13" reel Plastic tape: 24 mm wide, 0.33 mm thick, 12 mm pocket spacing, 5.8 mm pocket depth

PCB washing Tested to MIL-STD-202 Method 215 plus an additional aqueous wash. See [Doc787_PCB_Washing.pdf](#).

| Part number ¹ | L ±20% ² (µH) | DCR max (Ohms) | SRF typ (MHz) | Isat ³ (A) | Irms ⁴ (A) |
|--------------------------|--------------------------------|----------------------|---------------------|--------------------------|--------------------------|
| DS3316P-102ML_ | 1.0 | 0.021 | 140 | 11.0 | 5.0 |
| DS3316P-152ML_ | 1.5 | 0.022 | 120 | 9.5 | 4.5 |
| DS3316P-222ML_ | 2.2 | 0.032 | 80 | 7.8 | 3.8 |
| DS3316P-332ML_ | 3.3 | 0.039 | 70 | 6.0 | 3.3 |
| DS3316P-472ML_ | 4.7 | 0.054 | 40 | 5.4 | 2.7 |
| DS3316P-682ML_ | 6.8 | 0.075 | 38 | 4.5 | 2.2 |
| DS3316P-822ML_ | 8.2 | 0.085 | 36 | 4.0 | 2.1 |
| DS3316P-103ML_ | 10 | 0.101 | 35 | 3.5 | 2.0 |
| DS3316P-153ML_ | 15 | 0.150 | 25 | 3.0 | 1.5 |
| DS3316P-223ML_ | 22 | 0.207 | 19 | 2.0 | 1.3 |
| DS3316P-333ML_ | 33 | 0.334 | 15 | 1.8 | 1.1 |
| DS3316P-473ML_ | 47 | 0.472 | 13 | 1.4 | 0.80 |
| DS3316P-683ML_ | 68 | 0.660 | 10 | 1.3 | 0.70 |
| DS3316P-104ML_ | 100 | 1.11 | 7 | 1.2 | 0.60 |
| DS3316P-154ML_ | 150 | 1.55 | 6 | 0.80 | 0.50 |
| DS3316P-224ML_ | 220 | 2.00 | 5 | 0.70 | 0.37 |
| DS3316P-105ML_ | 1000 | 8.30 | 2 | 0.32 | 0.17 |

1. When ordering, please specify **termination** and **packaging** codes:

DS3316P-105MLD

Termination: L = RoHS compliant electroplated gold (<50 µin) over nickel over phos bronze.

Special order: T = RoHS tin-silver-copper (95.5/4/0.5) or S = non-RoHS tin-lead (63/37).

Packaging: D = 13" machine-ready reel. EIA-481 embossed plastic tape (1000 parts per full reel).

B = Less than full reel. In tape, but not machine ready.

To have a leader and trailer added (\$25 charge), use code letter D instead.

2. Inductance tested at 0.1 Vrms, 100 kHz, 0 Adc.

3. DC current at 25°C that causes an inductance drop of 10% (typ) from its value without current. [Click for temperature derating information.](#)

4. Current that causes a 40°C temperature rise from 25°C ambient. This information is for reference only and does not represent absolute maximum ratings. [Click for temperature derating information.](#)

5. Electrical specifications at 25°C.

Refer to Doc 362 "Soldering Surface Mount Components" before soldering.

SPICE models ON OUR WEB SITE



www.coilcraft.com

US +1-847-639-6400 sales@coilcraft.com

UK +44-1236-730595 sales@coilcraft-europe.com

Taiwan +886-2-2264 3646 sales@coilcraft.com.tw

China +86-21-6218 8074 sales@coilcraft.com.cn

Singapore + 65-6484 8412 sales@coilcraft.com.sg

Document 187-1 Revised 06/04/16

© Coilcraft Inc. 2016

This product may not be used in medical or high risk applications without prior Coilcraft approval. Specification subject to change without notice. Please check web site for latest information.



SMT Power Inductors - DS3316P Series

Typical L vs Frequency

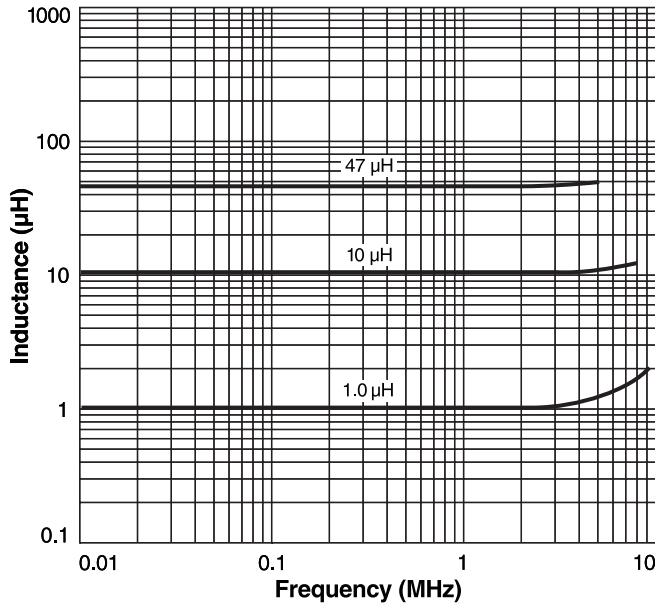

Typical L vs Current

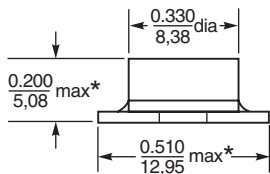
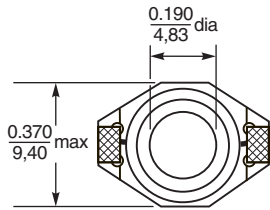
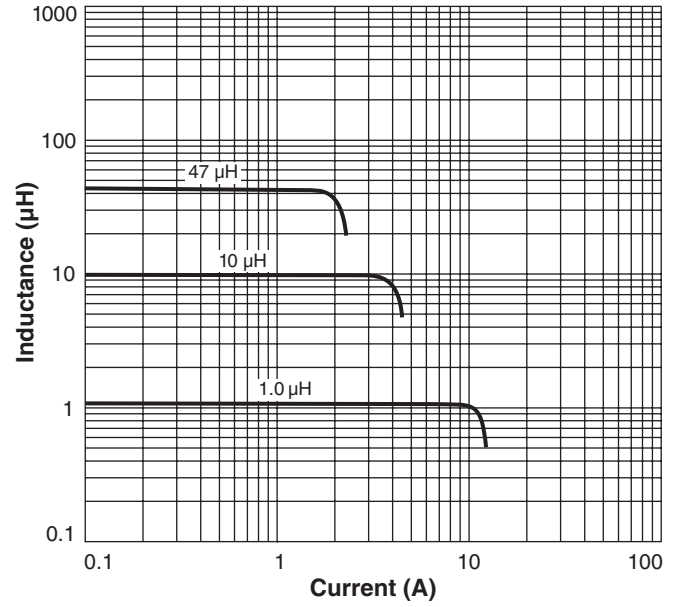

* Allow an additional 0.01/0.254 in length and 0.005/0.127 in height for optional tin-lead and tin-silver-copper application.

Recommended Land Pattern

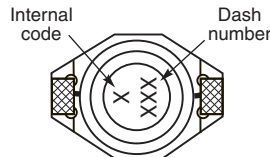
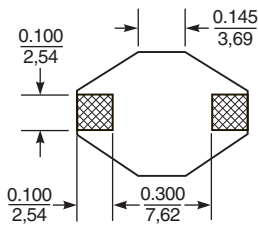
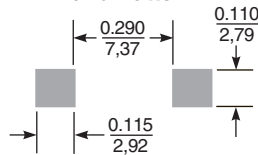

Part marking since Feb. 2005. Parts manufactured prior to that date may have color dots. Visit www.coilcraft.com/coilpowr.cfm for color dot marking details.

Dimensions are in $\frac{\text{inches}}{\text{mm}}$



US +1-847-639-6400 sales@coilcraft.com
UK +44-1236-730595 sales@coilcraft-europe.com
Taiwan +886-2-2264 3646 sales@coilcraft.com.tw
China +86-21-6218 8074 sales@coilcraft.com.cn
Singapore + 65-6484 8412 sales@coilcraft.com.sg

Document 187-2 Revised 06/04/16

© Coilcraft Inc. 2016

This product may not be used in medical or high risk applications without prior Coilcraft approval. Specification subject to change without notice. Please check web site for latest information.