

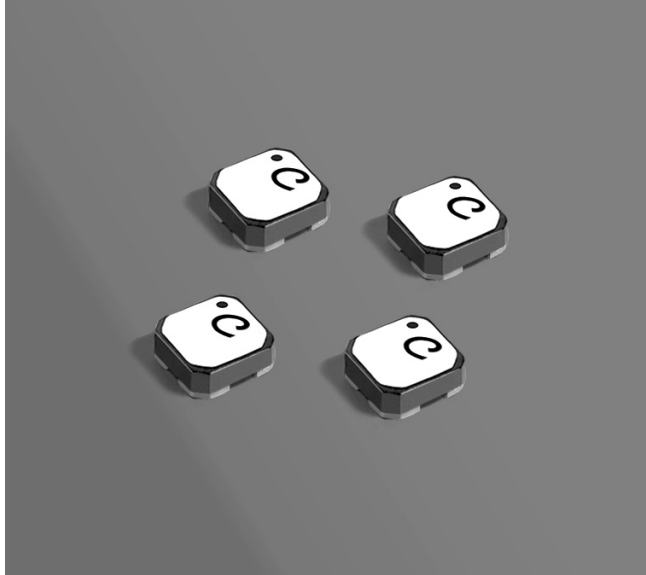

Shielded Coupled Inductor

For Maxim
MAX14521E



- Developed for Maxim MAX14521E High-Voltage EL Lamp Driver with I²C Interface
- Used as a 1 : 8 autotransformer
- Shielded part for high-density applications

Core material Ferrite

Environmental RoHS compliant, halogen free optional

Terminations RoHS compliant silver-palladium-platinum-glass frit.

Weight 32 mg

Ambient temperature -40°C to +85°C with I_{rms} current, +85°C to +125°C with derated current

Storage temperature Component: -40°C to +125°C.

Tape and reel packaging: -40°C to +80°C

Resistance to soldering heat Max three 40 second reflows at +260°C, parts cooled to room temperature between cycles

Temperature Coefficient of Inductance (TCL) +50 to +150 ppm/°C

Moisture Sensitivity Level (MSL) 1 (unlimited floor life at <30°C / 85% relative humidity)

Failures in Time (FIT) / Mean Time Between Failures (MTBF)

38 per billion hours / 26,315,789 hours, calculated per Telcordia SR-332

Packaging 1000/7" reel; 3500/13" reel; Plastic tape: 12 mm wide, 0.23 mm thick, 8 mm pocket spacing, 1.4 mm pocket depth

PCB washing Only pure water or alcohol recommended

| Part number ¹ | Inductance ±20% (μH) ² | | DCR max (Ohms) | | Turns ratio L1 : L2 | Isat ³ (A) |
|--------------------------|-----------------------------------|-----|----------------|-------|---------------------|-----------------------|
| | L1 | L2 | L1 | L2 | | |
| GA3250-BL_ | 1.9 | 112 | 1.29 | 11.19 | 1 : 8 | 0.7 |

1. When ordering, please specify **termination** and **packaging** codes:

GA3250-BLC

Termination: L = RoHS compliant silver-palladium-platinum-glass frit.

E = Halogen free component. RoHS compliant silver-palladium-platinum-glass frit terminations.

Special order, added cost:

T = RoHS tin-silver-copper (95.5/4/0.5) or

S = non-RoHS tin-lead (63/37).

Packaging: C = 7" machine-ready reel. EIA-481 embossed plastic tape (1000 parts per full reel).

B = Less than full reel. In tape, but not machine ready. To have a leader and trailer added (\$25 charge), use code letter C instead.

D = 13" machine-ready reel. EIA-481 embossed plastic tape. Factory order only, not stocked (3500 parts per full reel).

2. Inductance measured at 100 kHz, 0.1 Vrms, 0 Adc using an Agilent/HP 4284A LCR meter or equivalent.

3. DC current at which the inductance of L1 drops 20% (typ) from its value without current.

4. Electrical specifications at 25°C.

Refer to Doc 362 "Soldering Surface Mount Components" before soldering.

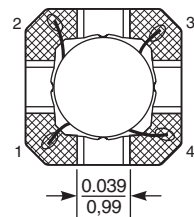
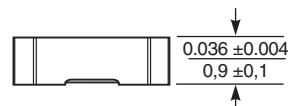
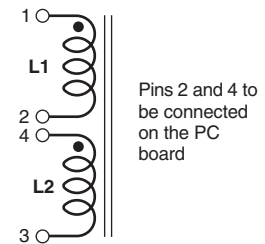
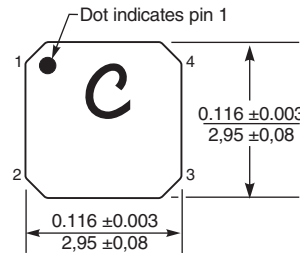

Dimensions are in inches
mm

Recommended Land Pattern

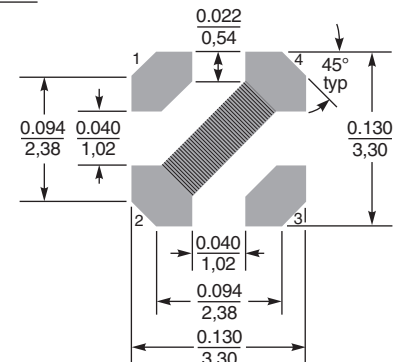

Cover area with solder mask.



www.coilcraft.com

US +1-847-639-6400 sales@coilcraft.com

UK +44-1236-730595 sales@coilcraft-europe.com

Taiwan +886-2-2264 3646 sales@coilcraft.com.tw

China +86-21-6218 8074 sales@coilcraft.com.cn

Singapore +65-6484 8412 sales@coilcraft.com.sg

Document 717 Revised 12/11/12

© Coilcraft Inc. 2012

This product may not be used in medical or high risk applications without prior Coilcraft approval. Specification subject to change without notice. Please check out web site for latest information.