



# Shielded Power Inductors – DS3316P



Coilcraft will continue to manufacture and support the DS3316P indefinitely, however for new designs, consider the MSS1038 as an alternative. The MSS1038 series is more cost effective, features a smaller footprint, lower profile, lower DCR and better current handling.

**Core material** Ferrite

**Terminations** RoHS compliant electroplated gold (<50 µm) over nickel over phos bronze. Other terminations available at additional cost.

**Weight** 0.82– 0.87 g

**Ambient temperature** –40°C to +85°C with Irms current

**Maximum part temperature** +125°C (ambient + temp rise)

**Storage temperature** Component: –40°C to +125°C.

Tape and reel packaging: –40°C to +80°C

**Resistance to soldering heat** Max three 40 second reflows at +260°C, parts cooled to room temperature between cycles

**Moisture Sensitivity Level (MSL)** 1 (unlimited floor life at <30°C / 85% relative humidity)

**Packaging** 1000 per 13" reel Plastic tape: 24 mm wide, 0.33 mm thick, 12 mm pocket spacing, 5.8 mm pocket depth

**PCB washing** Tested to MIL-STD-202 Method 215 plus an additional aqueous wash. See [Doc787\\_PCB\\_Washing.pdf](#).

Part number <sup>1</sup>	L ±20% <sup>2</sup> (µH)	DCR max (Ohms)	SRF typ (MHz)	Isat <sup>3</sup> (A)	Irms <sup>4</sup> (A)
DS3316P-102ML_	1.0	0.021	140	11.0	5.0
DS3316P-152ML_	1.5	0.022	120	9.5	4.5
DS3316P-222ML_	2.2	0.032	80	7.8	3.8
DS3316P-332ML_	3.3	0.039	70	6.0	3.3
DS3316P-472ML_	4.7	0.054	40	5.4	2.7
DS3316P-682ML_	6.8	0.075	38	4.5	2.2
DS3316P-822ML_	8.2	0.085	36	4.0	2.1
DS3316P-103ML_	10	0.101	35	3.5	2.0
DS3316P-153ML_	15	0.150	25	3.0	1.5
DS3316P-223ML_	22	0.207	19	2.0	1.3
DS3316P-333ML_	33	0.334	15	1.8	1.1
DS3316P-473ML_	47	0.472	13	1.4	0.80
DS3316P-683ML_	68	0.660	10	1.3	0.70
DS3316P-104ML_	100	1.11	7	1.2	0.60
DS3316P-154ML_	150	1.55	6	0.80	0.50
DS3316P-224ML_	220	2.00	5	0.70	0.37
DS3316P-105ML_	1000	8.30	2	0.32	0.17

1. When ordering, please specify **termination** and **packaging** codes:

**DS3316P-105MLD**

**Termination:** **L** = RoHS compliant electroplated gold (<50 µm) over nickel over phos bronze.

Special order: **T** = RoHS tin-silver-copper (95.5/4/0.5) or **S** = non-RoHS tin-lead (63/37).

**Packaging:** **D** = 13" machine-ready reel. EIA-481 embossed plastic tape (1000 parts per full reel). Quantities less than full reel available: in tape (not machine ready) or with leader and trailer (\$25 charge).

**B** = Less than full reel. In an effort to simplify our part numbering system, Coilcraft is eliminating the need for multiple packaging codes. When ordering, simply change the last letter of your part number from B to D.

2. Inductance tested at 0.1 Vrms, 100 kHz, 0 Adc.

3. DC current at 25°C that causes an inductance drop of 10% (typ) from its value without current. [Click for temperature derating information.](#)

4. Current that causes a 40°C temperature rise from 25°C ambient. This information is for reference only and does not represent absolute maximum ratings. [Click for temperature derating information.](#)

5. Electrical specifications at 25°C.

Refer to Doc 362 "Soldering Surface Mount Components" before soldering.

**SPICE models** ON OUR WEB SITE



www.coilcraft.com

**US** +1-847-639-6400 sales@coilcraft.com

**UK** +44-1236-730595 sales@coilcraft-europe.com

**Taiwan** +886-2-2264 3646 sales@coilcraft.com.tw

**China** +86-21-6218 8074 sales@coilcraft.com.cn

**Singapore** + 65-6484 8412 sales@coilcraft.com.sg

Document 187-1 Revised 06/04/16

© Coilcraft Inc. 2021

This product may not be used in medical or high risk applications without prior Coilcraft approval. Specification subject to change without notice. Please check web site for latest information.



# SMT Power Inductors - DS3316P Series

## Typical L vs Frequency

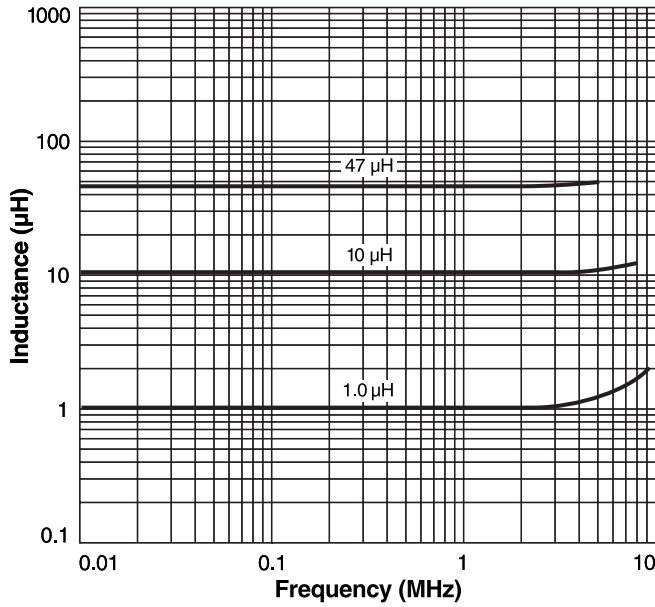

## Typical L vs Current

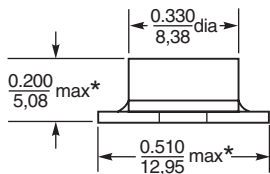
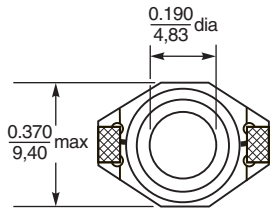
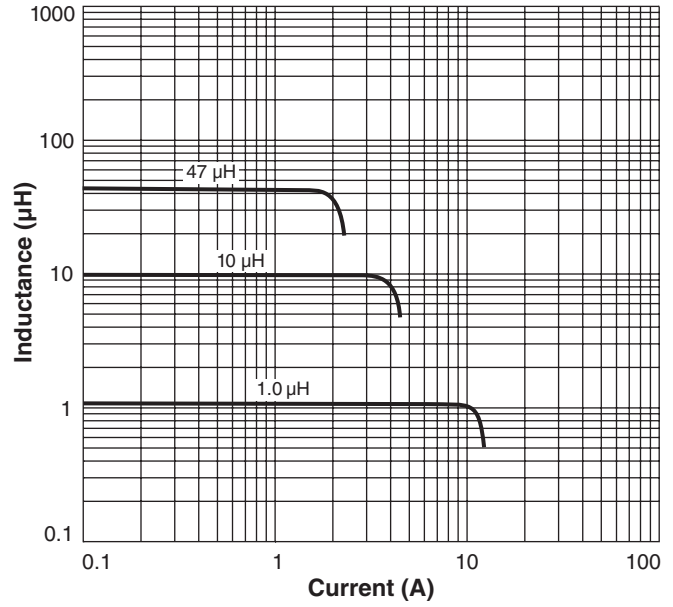

\* Allow an additional 0.01/0,254 in length and 0.005/0,127 in height for optional tin-lead and tin-silver-copper application.

### Recommended Land Pattern

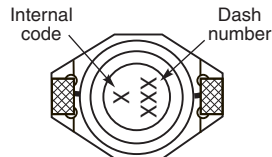
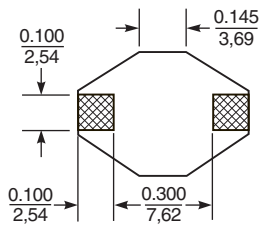
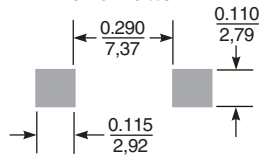

Part marking since Feb. 2005. Parts manufactured prior to that date may have color dots. Visit [www.coilcraft.com/colrpowr.cfm](http://www.coilcraft.com/colrpowr.cfm) for color dot marking details.

Dimensions are in  $\frac{\text{inches}}{\text{mm}}$



**US** +1-847-639-6400 sales@coilcraft.com  
**UK** +44-1236-730595 sales@coilcraft-europe.com  
**Taiwan** +886-2-2264 3646 sales@coilcraft.com.tw  
**China** +86-21-6218 8074 sales@coilcraft.com.cn  
**Singapore** + 65-6484 8412 sales@coilcraft.com.sg

Document 187-2 Revised 06/04/16

© Coilcraft Inc. 2021

This product may not be used in medical or high risk applications without prior Coilcraft approval. Specification subject to change without notice. Please check web site for latest information.